

Before installing the power supply, you should:

- mount the I/O chassis that the power supply will be connected to. See the Universal I/O Chassis Installation Data (1771-2.210) for information on mounting the I/O chassis.
- set the power supply configuration jumper on the I/O chassis. The 1771-P7 is an external power supply. Set the configuration jumper to the N position.

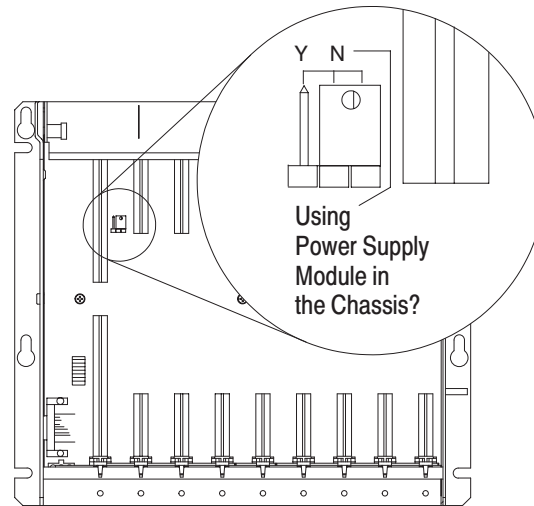

12620-1

## Install the 1771-P7 and Connect Backplane Power

The power supply has a D-shell power connector that provides power to the I/O chassis backplane.

- A1 backplane common
- A2 backplane +5V dc
- 1 no connection
- 2 backplane processor enable
- 3 backplane +5V dc sense
- 4 backplane signal ground sense
- 5 no connection

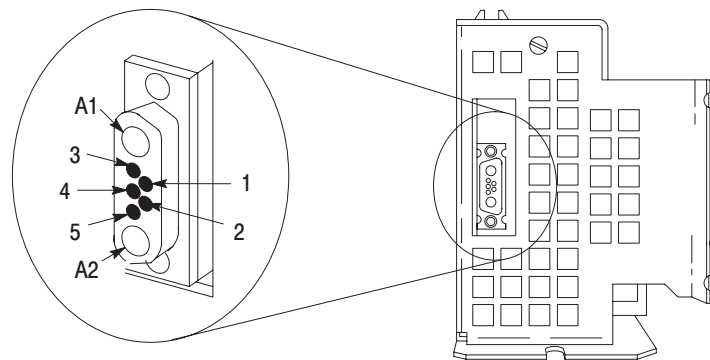

bottom view of power supply

13445

If you have this I/O chassis	Use this power cable <sup>1</sup>	To connect a 1771-P7 mounted
1771-A3B	1771-CP2	within 1.52m (5ft) of the I/O chassis
1771-A1B, -A2B, -A3B1, or -A4B	1771-CP1	within 0.32m (1.04ft) on the left-side of the I/O chassis
	1771-CP2	within 1.52m (5ft) of the I/O chassis
	1771-CP3 (right angle connector)	within 1.68m (5.5ft) of the I/O chassis

<sup>1</sup> Power supply cable is not shipped with the power supply.

If you are mounting the power supply	Go to
on the left side of a panel-mounted I/O chassis	next section
separately from an I/O chassis	page 9

## Attaching to a Panel-mounted I/O Chassis

1. Attach the mounting screws to the side of the I/O chassis:

### ATTENTION



Use the mounting screws provided with the 1771-P7. Longer screws may intrude into the I/O chassis and interfere with module insertion.

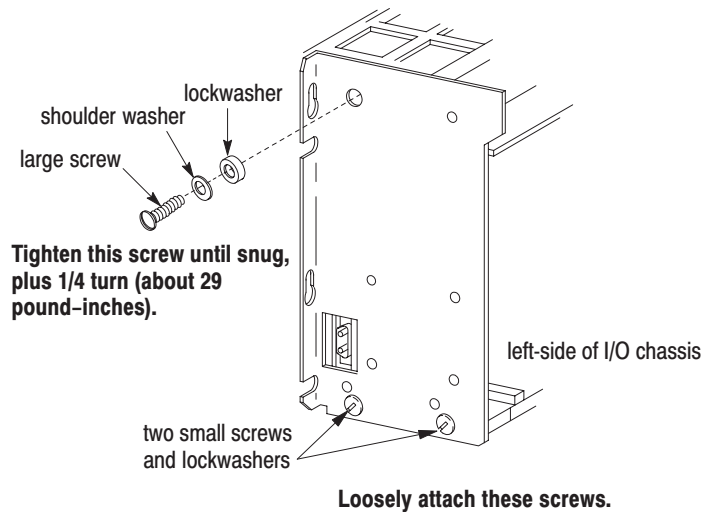

13446

2. Connect the power cable (ordered separately) to the D-shell connector on the I/O chassis and tighten the connector screws.

### WARNING



If you connect or disconnect the power supply cable with power applied an electrical arc can occur. This could cause an explosion in hazardous location installations. Be sure power is removed or the area is nonhazardous before proceeding.

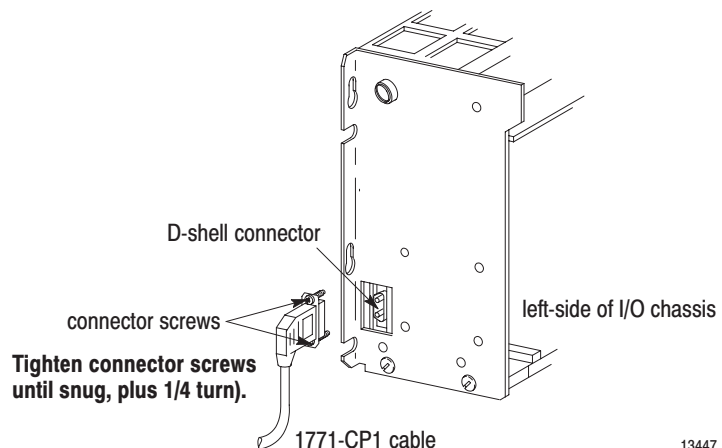

13447

3. Slide the power supply onto the left side of the chassis:

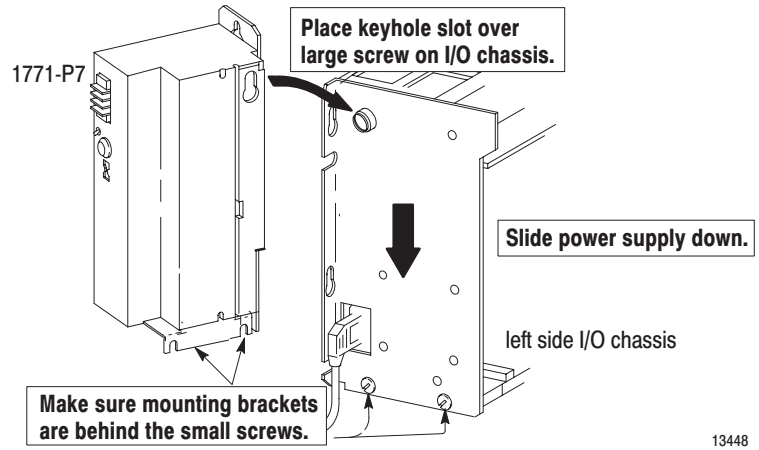

4. Tighten the small screws until snug, plus 1/4 turn (about 29 pound-inches), to secure the power supply to the I/O chassis.

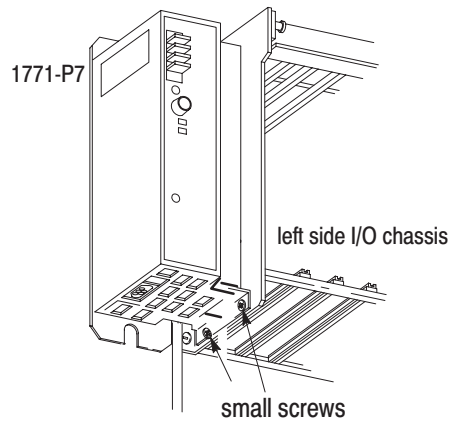

5. Attach the other end of the power cable to the D-shell connector on the bottom of the power supply and tighten the connector screws.

**WARNING**

If you connect or disconnect the power supply cable with power applied an electrical arc can occur. This could cause an explosion in hazardous location installations. Be sure power is removed or the area is nonhazardous before proceeding.

---

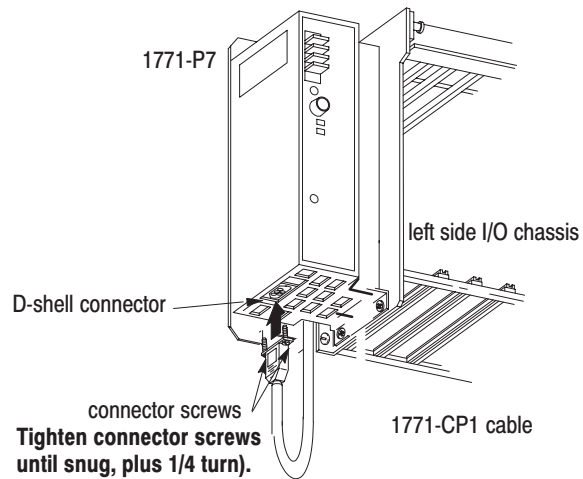

13449